

KP Series

Portable Systems

LUBE & HYDRAULIC OIL FILTRATION

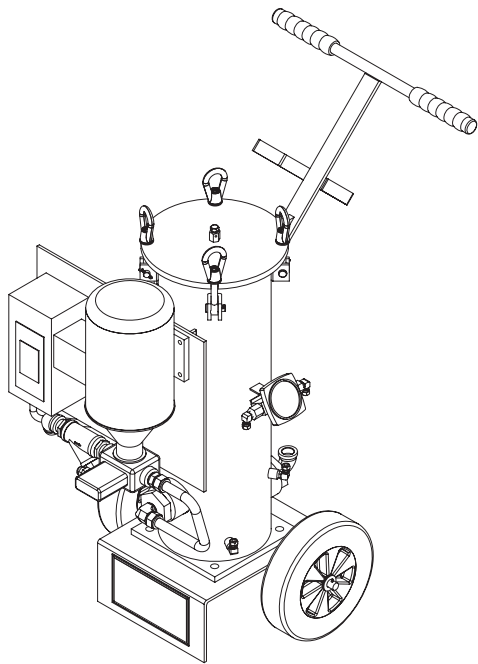

The KP Series sets the standard for industrial oil filtration, delivering continuous removal of harmful particulates and water to safeguard critical equipment and maximize uptime.

- **High-efficiency contaminant removal:** Efficiently eliminates particulates and water from lube and hydraulic oils, reducing the risk of equipment wear and unplanned maintenance
- **Continuous protection:** Designed for around-the-clock operation, supporting long-term reliability in demanding industrial environments
- **Versatile application:** Proven performance in steel and aluminum mills, paper mills, and other heavy industries where oil cleanliness is critical
- **Rapid oil conditioning:** Quickly restores oil quality during shutdowns, preparing systems for efficient and trouble-free startup
- **Customizable solutions:** Available with a range of options and configurations to meet specific operational requirements

The KP Series ensures your lubrication and hydraulic systems operate at peak performance-minimizing downtime, extending equipment life, and delivering confidence in every run.

Specifications	KP-618-5	KP-636-5	KP-636-10
System Flow (max.)	5 gpm (19 lpm)	5 gpm (19 lpm)	10 gpm (38 lpm)
Sizing	For use with reservoirs up to 600 gallons (2,270 liters)		
System Pressure	100 psig / 7 bar		
Environmental Parameters	NEMA 4 (moisture proof and dust proof) Minimum Temperature: 32°F (0°C) Maximum Temperature: 104°F (40°C)		
Materials of Construction	Metals: Bronze, Carbon Steel, Stainless Steel Elastomers: Buna-N		
Inlet/Outlet Connections	Inlet: 1" (25.4 mm) NPT Outlet: 1" (25.4 mm) NPT		
Pump/Motor Assembly	Pump: positive displacement (sliding vane type) Motor: 1HP		
Operating Voltage	120 VAC / 1PH / 60 Hz		
Fluid Compatibility	Petroleum Based Fluids (maximum viscosity = ISO 320 at 100 °F)		
Element Life Indicator	Type: Visual - Gauge Measurement: Differential Pressure Range: 0 - 40 psid		
Recommended Change-Out DP	25 psid / 1.7 bar		
Weight (Dry)	180 lbs (82 kg)	215 lbs (98 kg)	
Dimensions (LxWxH)	30 x 24 x 36 inches 760 x 610 x 915 mm	30 x 24 x 54 inches 760 x 610 x 1370 mm	



KAYDON FILTRATION
Filtration Group®



Scan QR Code to find our locations

kaydonfiltration@filtrationgroup.com
www.kaydonfiltration.com